



	Page
2007 General Conference Information & Highlights.....	2
Welcome Letters	5
Conference Schedule.	7
Description of Sessions	12
Speakers.....	20
About NAME, Inc	30
Conference Sponsors	33



Registration Desk

The registration desk is located outside of the Nicollet Ballrooms-1st floor. The registration desk will be staffed during all conference times. Attendees may post messages on the message board located in the registration area.

Cyber Café (Email Service)

The complimentary cyber café is located in the Loring Room-1st floor. The e-mail stations will be available on Tuesday from noon to 7:00 pm, on Wednesday and Thursday from 6:30 am to 8:00 pm and on Friday from 6:30 am to 3:00 pm.

Certification of Attendance

A certification of attendance is included in your registration packet. Certifications will be mailed to any attendees who registered late.

Attire

Business casual for the entire conference.

Evaluations

An overall conference evaluation will be emailed to attendees after the conference. In addition, each break out session will have an evaluation which is distributed by the session moderator. Please take time to complete all evaluations. Your comments will assist next year's conference committee to continue to improve the conference.

Silent Auction for Local Charity: In thanks to the Twin Cities for hosting the 5th Annual NAME, Inc. Conference, NAME will be holding a Charity Silent Auction. The auction benefits a local charity committed to supporting children and youth in the community. This year all proceeds will be donated to LIFE LONG MENTORING SERVICES, INC., an organization that focuses on "Bridging the Gap for At-Risk Youth, between Communities, Families and Institutions." This organization provides mentoring and life skill services for "at risk" students. Many of these students receive services in special education and may be involved in the juvenile justice system. Mr. Corey Bird will be presenting an overview of the services that are provided through LIFE LONG MENTORING SERVICES, INC. at the Charity Luncheon on Wednesday, September 26th at noon.

At the 4th Annual NAME Conference in Indianapolis over \$1000 was raised and given to Rupert's Kids, an Indianapolis-based organization that provides mentoring and educational programming for at-risk youth who live in the Indianapolis area.

NAME encourages each attendee to donate items for the auction. The items donated for the auction this year reflect a "**Twin Cities**" theme - anything that is a twin, such as pairs, exact opposites, doubles, look-alikes, mirror images...

Attendees can drop off item(s) when registering. Receipts for donated items are available at the registration desk. The Auction will commence when the first item appears on Wednesday

and bidding will close at the start of the first session on Friday. Winning bids will be posted after the 10:45 am, Friday morning break at which time payment for items can be made (cash, check, or VISA/Mastercard credit card). Winning bidders who are not present will be notified at a later date. Shipping options will be available to send auction items home.

Sponsor Display Area: Please take time on Wednesday and Thursday between 7:00 am and 5:00 pm to stop by the sponsor exhibits, view and discuss their products and services, and to thank them for their generosity. The sponsors graciously supported NAME's efforts to hold this conference and also have a significant amount of knowledge to share. The sponsor exhibit area is conveniently located in Nicollet B/C-1st floor.

Welcome Reception: This event is for registrants and their adult guests. Join colleagues in the Regency Room-2nd floor on Wednesday from 5:00 pm to 7:00 pm to enjoy hors d'oeuvres, a cash bar, and relax, network, meet old friends and make new ones!

Session Materials: Handouts from all sessions will be available throughout the conference and will be posted on the NAME web site after the conference adjourns. See www.MedicaidforEducation.org.

New Member Breakfast: All new members are cordially invited to attend the new member breakfast on Wednesday morning. Breakfast for those who are new to NAME will be provided in the Regency Room – 2nd floor beginning at 7:00 am. A program introducing new members to NAME will begin at 7:30 am. You will also be able to meet the NAME Board and Committee Chairs.

Committee Breakfast: Thursday morning, all NAME committee members will have an opportunity to have breakfast together at a designated table in Nicollet D-1st Floor. Committee chairs will decide if this time will include a formal meeting or just an occasion to get together and meet each other over coffee. Any attendees who have an interest in joining a committee may join the committee members for breakfast. Look for signs on the tables to identify the committee meeting locations.

NAME Networking Niche: Looking for a place during the conference to continue a discussion, have a meeting or just share ideas with colleagues? Two meeting rooms are available for large or small gatherings. Each room holds approximately 40 people. The networking rooms are the Skyway Suites A and B-2nd floor. Please feel free to use them throughout the conference.

Hotel Map: General sessions and breakout sessions are held in multiple locations throughout the hotel. A map has been provided to assist you in locating the correct room.

Hyatt Regency Minneapolis

MEETING ROOM FLOOR PLANS

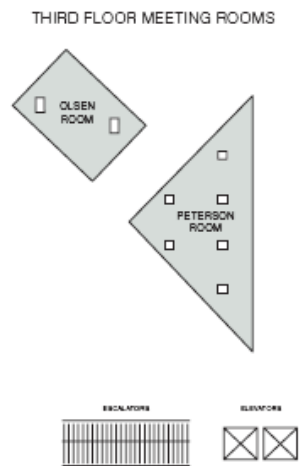
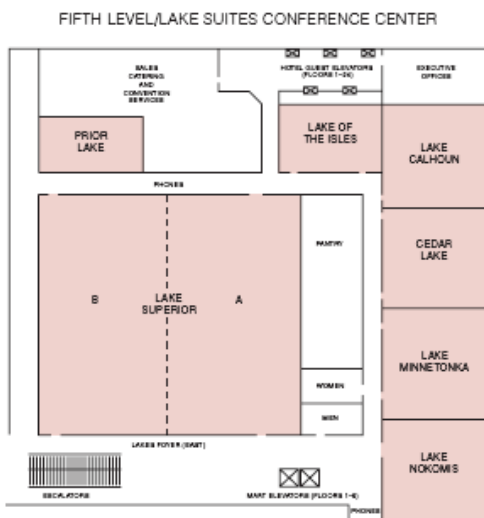
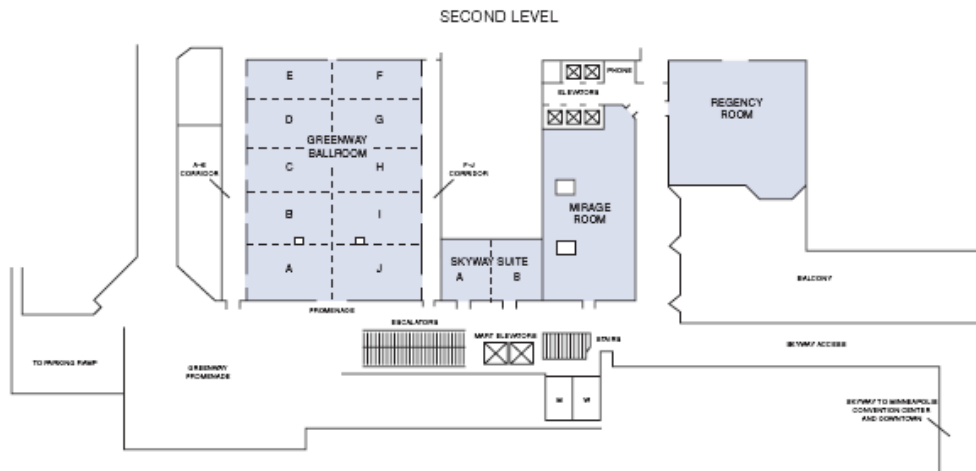
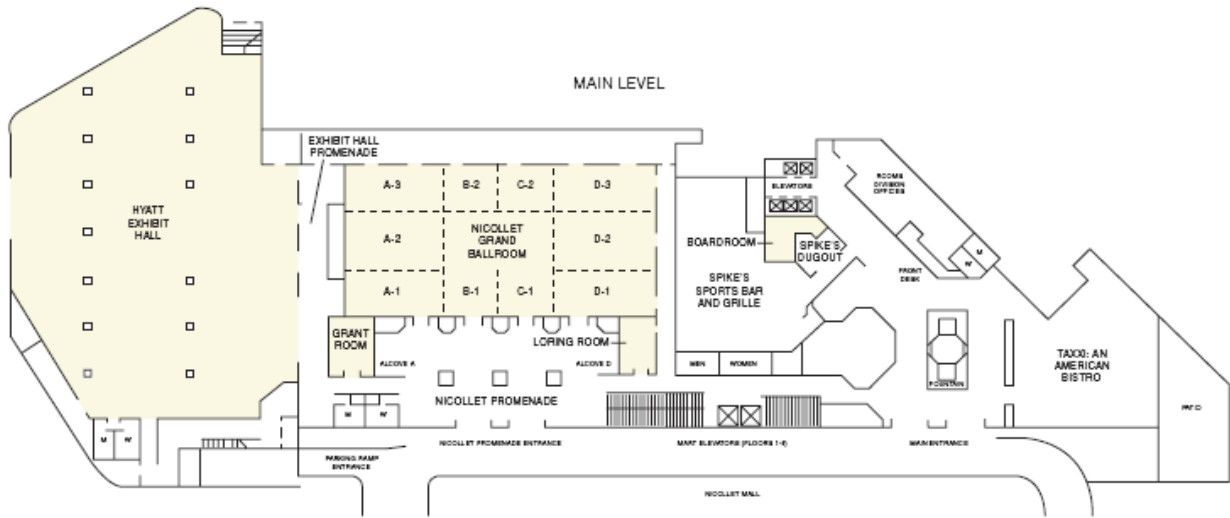



September 26, 2007

To all conference participants:

On behalf of Governor Tim Pawlenty I want to welcome all of you to the 5th annual National Alliance for Medicaid in Education (NAME) Conference. The work that you are doing to bridge Medicaid and Special Education is incredibly important to the development and success of our students.

NAME's commitment to connecting people and providing a better understanding of these programs provides a foundation to better serve students with special needs.

I want to thank Cathy Griffin for hosting this important event, and I wish to give a sincere thank you to all of you for attending.

Once again, welcome, and please continue with the important work that you do.

Sincerely,

A handwritten signature in black ink that reads "Alice Seagren". The signature is written in a cursive style.

Alice Seagren
Commissioner

N A M E

National Alliance for Medicaid in Education, Inc.

2007 Officers

Brenda Mack-Bowman, President
Delaware Dept. of Education

Elizabeth Touhey, Pres.-Elect
California Dept. of Health Services

Terrie Belton, Secretary
Georgia Dept of Community Health

Dann Stevens, Treasurer
Iowa Dept. of Education

Cathy Griffin, Past President
Minnesota Dept. of Education

Board Members

Denise Achin, Region I
Rhode Island Dept of Education

Michael Albino, Region II
New York Dept of Health

Amy Edwards, Region III
Virginia Dept. of Education

Nora Poisella, Region IV
North Carolina Division of Medical Assistance.

John Hill, Region V
Indiana Dept. of Education

Kari Armijo, Region VI
New Mexico Dept. of Human Services

Vacant, Region VII

Emily Tryer, Region VIII
Colorado Dept. of Education

Melinda Hollinshead, Region IX
Arizona Medicaid (AHCCCS)

Michelle Lyons-Brown, Region X
Alaska Dept. of Health & Human Ser.

Kathleen Cummins Merry,
LEA Rep. I
Wayne RESA (MI)

Barb Neely, LEA Rep. II
Multnomah ESD (OR)

*Providing a network
among stakeholders
to share information
on issues pertinent to
Medicaid programs in
public schools.*

Welcome letter from NAME 2007 President

Welcome to the 2007 National Alliance for Medicaid in Education, Inc. (NAME) Conference! Fall is a great time to be in Minneapolis where you can enjoy the natural wonders of this state with 10,000 lakes.

The theme for this conference is "Bridge to Understanding." NAME is striving to help attendees better understand Medicaid and Special Education, with seminars, breakout sessions, breakfast sessions and forums that bridge the two programs. The NAME Conference members have worked hard to present a program that enhances our knowledge and motivates us to connect the policies, services and people while remaining focused on outcomes for children and students.

In order to assess whether we have indeed met your needs, please give us your comments and suggestions on the conference evaluation forms. In addition, do not hesitate to share your thoughts with NAME Officers and Board of Directors. Your feedback is essential in order for NAME to meet your needs.

It is my sincere hope that you will find the conference to be a valuable experience, educationally, professionally, and socially. The conference will provide you with many opportunities to learn, to interact, and to exchange ideas with your colleagues, as well as have a good time in Minneapolis.

NAME is pleased that you are participating in this conference and we look forward to your continuing involvement in NAME activities. Again, welcome and thank you for your attendance!

Sincerely,



Brenda Mack-Bowman, President
National Alliance for Medicaid in Education, Inc.
(302) 735-4071
bmack@doe.k12.de.us

In the NAME of Collaboration
www.medicaidforeducation.org

Conference Schedule



Noon-7:00 pm	Registration/Auction Item Drop Off	Nicollet Promenade-1 st Floor
Noon-6:00 pm	Exhibit Set-Up	Nicollet D-1 st Floor
Noon-7:00 pm	Cyber Café (Email Service)	Loring Room-1 st Floor
Noon-7:00 pm	NAME'S Networking Niche	Skyway A & B
1:00 pm-4:30 pm	<p>Academy <i>Understanding Medicaid in Education</i></p> <p><i>Medicaid 101</i> <i>Nora Poisella, North Carolina Department of Human Services</i> <i>Elizabeth Touhey, California Department of Health Services</i></p> <p><i>IDEA 101</i> <i>Cathy Griffin, Minnesota Department of Education</i> <i>Dann Stevens, Iowa Department of Education</i></p> <p><i>Marrying Medicaid to IDEA</i> <i>Cathy Griffin, Barbara Neely, Multnomah ESD,</i> <i>Nora Poisella, Dann Stevens, and Elizabeth Touhey</i></p>	Lake Nokomis-5 th Floor



7:00 am-5:00 pm	Registration/Auction Item Drop Off	Nicollet Promenade-1 st Floor
7:00 am-5:00 pm	Exhibits	Nicollet D-1 st Floor
6:30 am-8:00 pm	Cyber Café (Email Service)	Loring Room-1 st Floor

7:00 am-5:00 pm	Silent Auction Bidding	Nicollet D-1 st Floor
7:00 am-8:00 pm	NAME'S Networking Niche	Skyway A & B
7:00 am-8:15 am	New Member Breakfast: Hosted by Tricia Krotenberg and Dann Stevens (Introduction to NAME Inc. begins at 7:30 am)	Regency Room-2 nd Floor
7:00 am-8:30 am	Breakfast	Nicollet B/C-1 st Floor
8:30 am-10:15 am	General Session: <i>Minnesota Hello</i> <i>Cathy Griffin, Minnesota Department of Education</i> <i>NAME Update</i> <i>Brenda-Mack Bowman, NAME President</i> <i>Washington Update</i> <i>Bruce Hunter, Executive Director, American Association of School Administrators</i> <i>Nancy Reder, Deputy Executive Director, National Association of State Directors of Special Education</i>	Nicollet B/C-1 st Floor
10:15 am-10:30 am		Nicollet D-1 st Floor
10:30 am-Noon	Morning Break Keynote Address <i>Medicaid in 2007: Understanding Trends, Issues and Policy Directions and their Implications for School Based Health in the Future.</i> <i>Dr. Vernon Smith, Principal, Health Management Associates</i>	Nicollet B/C-1 st Floor
Noon-1:10 pm	Charity Luncheon: <i>Introduction to Life Long Mentoring Services and Their Work</i>	Greenway Ballroom-2 nd Floor
1:15 pm-2:45 pm	General Session <i>Rules...Rules...Rule...2258...2287....226</i> <i>Greg Morris, Attorney at Law</i> <i>John Hill, Indiana Department of Education</i>	Nicollet B/C-1 st Floor
2:45 pm-3:00 pm	Afternoon Break	Nicollet D-1 st Floor
3:00 pm-5:00 pm	NAME Nuggets: <ul style="list-style-type: none"> • <i>Targeted Case Management</i> • <i>Service Documentation</i> • <i>False Claims Act</i> • <i>National Issues</i> • <i>Random Moment Sampling</i> • <i>PERM Audits</i> • <i>Medical vs. Education</i> • <i>Section 504 in Schools</i> • <i>Billing for Medicaid Services on Your Own</i> 	Greenway Ballroom-2 nd Floor Ballroom A Ballroom J Ballroom B Ballroom I Ballroom C Ballroom H Ballroom D Ballroom G Ballroom E
5:00 pm-7:00 pm	Reception	Regency-2 nd Floor



Thursday, September 27, 2007

7:00 am-5:00 pm	Registration	Nicollet Promenade-1 st Floor
7:00 am-5:00 pm	Exhibits	Nicollet D-1 st Floor
6:30 am-8:00 pm	Cyber Café (Email Service)	Loring Room-1 st Floor
7:00 am-5:00 pm	Silent Auction Bidding	Nicollet D-1 st Floor
7:00 am-8:00 pm	NAME'S Networking Niche	Skyway A & B
7:00 am-8:30 am	Breakfast	Nicollet B/C-1 st Floor
7:30 am-8:30 am	NAME Committees Breakfast	Nicollet B/C-1 st Floor
8:30 am-10:15 am	Break Out Sessions <ul style="list-style-type: none"> <i>The Challenges of Rural and Urban District SBS Programs</i> <i>Developing Tools to Document Services-Two Experiences</i> <i>Staff and Parents Influence Success</i> <i>Bridging School District Internal IDEA Audits and Medicaid Fee-for-Service Programs—One District's Experience</i> 	Greenway Ballroom-2 nd Floor Ballroom A Ballrooms E/D Ballroom J Ballrooms H/I
10:15 am-10:30 am	Mid-Morning Break	Nicollet D-1 st Floor
10:30 am-12:15 pm	Break Out Sessions <ul style="list-style-type: none"> <i>Billing for Medicaid SBS on Your Own</i> <i>MAC Maintenance and Sustainability-Reports from States: Oregon and California</i> <i>Best Practices in Preparing for an Audit</i> <i>Cost Effectiveness of School-Based Health Centers</i> 	Greenway Ballroom-2 nd Floor Ballroom A Ballrooms F/G Ballrooms E/D Ballroom J
12:15 pm-1:15 pm	Luncheon	Nicollet B/C-1 st Floor
1:15 pm-2:45 pm	Break Out Sessions <ul style="list-style-type: none"> <i>School Based Services Billing-Parent Perspectives on Problems and Potential Solutions</i> <i>Connecting the Work of State Agencies</i> <i>Medicaid and School-Based Health Centers—Building Bridges</i> <i>PERM Audits—What Are They and How do They Impact School Based Services?</i> 	Greenway Ballroom-2 nd Floor Ballrooms B/C Ballroom A Ballroom J Ballrooms D/E

	<ul style="list-style-type: none"> • <i>Demonstration Project for Children with Fetal Alcohol Syndrome (FASD): A New Model for Community Service Delivery</i> 	Ballrooms F/G
2:45 pm-3:15 pm	Afternoon Break	Nicollet D-1 st Floor
3:15 pm-5:00 pm	Membership Discussions <ul style="list-style-type: none"> • <i>State attendees</i> • <i>LEA attendees</i> • <i>Vendor attendees</i> • <i>Other attendees</i> 	Greenway Ballroom-2 nd Floor Ballroom I Ballrooms D/G Ballroom J Ballroom B



7:00 am-1:00 pm	Registration	Nicollet Promenade-1 st Floor
7:00 am-10:45 am	Silent Auction Bidding	Nicollet D-1 st Floor
6:30 am-3:00 pm	Cyber Café (Email Services)	Loring Room-1 st Floor
7:00 am-1:00 pm	NAME'S Networking Niche	Skyway A & B
7:00 am-8:30 am	Breakfast	Nicollet B/C-1 st Floor
7:20 am-8:50 am	NAME Annual Meeting and Election	Nicollet B/C-1 st Floor
9:00 am-10:30 am	Closing Remarks: <i>Alice Seagren, Commissioner, Minnesota Department of Education</i>	Nicollet B/C-1 st Floor
	General Session: <i>Recent Medicaid State Plan Amendment Experiences</i> <i>Kathy Cummins Merry, Michigan</i> <i>Michelle Lyons-Brown, Alaska</i> <i>Nora Poisella, North Carolina</i> <i>Tracy Brunner, Indiana</i> <i>Sally Nadolsky, Iowa</i>	
10:30 am-10:45 am	Mid-Morning Break <i>Posting of Silent Auction Winners</i>	Nicollet D -1 st Floor
10:45 am-12:00 pm	General Session: <i>Summary of Membership Discussions and Action Plans</i> <i>Building our Bridge One Story at a Time</i>	Nicollet B/C-1 st Floor

12:00 pm-12:30 pm Closing Remarks Nicollet B/C-1st Floor
Bridge to the Future, Elizabeth Touhey, 2007-2008 NAME President

MN Goodbye and Final Announcements, Cathy Griffin, Minnesota Department of Education

1:00 pm-2:30 pm Board Meeting with Conference Committee Lake Nokomis-5th Floor



7:30 am-4:30 pm Board Meeting Lake Nokomis-5th Floor

Description of Sessions



Washington Update

This general session will provide a timely update on the status of the proposed legislation, rules and regulations as well as other activities taking place in Washington pertaining to the fields of Education and Medicaid School-Based Services by two nationally renowned experts.

Location: Nicollet B/C-1st Floor

Speaker: Bruce Hunter, American Association of School Administrators, VA
Nancy Reder, National Association of State Directors of Special Education, VA

Keynote Address: Medicaid in 2007: Understanding Trends, Issues and Policy Directions and their Implications for School Based Health in the Future

Medicaid has become the largest health care program in America. It will provide health coverage, during all or part of 2007, for over 60 million individuals – far more than any other program, including Medicare. Medicaid has become the financial glue that helps hold together and finance the health care safety net, including a large and growing share of mental health, public health and school-based health care.

For schools to benefit from the opportunity to obtain Medicaid reimbursement, it is necessary to understand the requirements imposed by Medicaid. Medicaid rules, which were designed for mainstream delivery of medical services, are often difficult to understand and even more difficult to comply with in a school setting. Meeting all the requirements is even more difficult when federal rules seem to change and to discourage Medicaid funded health care services in schools. Financial penalties for non-compliance can be large. From the perspective of a former state Medicaid director, this session is intended to provide an understanding of Medicaid, its current policy and spending trends, and the implications of those trends for the future availability of Medicaid funds for school health services.

Location: Nicollet B/C-1st Floor

Speaker: Dr. Vernon Smith, Principal, Health Management Associates, MI

Rules...Rules...Rules...2258...2287...2261

This session will present information about the various packages of proposed federal regulations released by the federal Centers for Medicare and Medicaid Services in 2007, with an overview, impact analysis and call to action. Attendees will learn how the proposed changes will affect children with disabilities, school districts and Medicaid programs around the country.

Location: Greenway Ballrooms B/C-2nd Floor

Speakers: John Hill, Indiana Department of Education, IN

Greg Morris, Attorney at Law, LEAnet Consulting Executive Director, MI

NAME Nuggets

Greenway Ballroom-2nd Floor

Presenter:

Targeted Case Management	Ballroom A
Service Documentation	Ballroom J
False Claims Act	Ballroom B
National Issues	Ballroom I
Random Moment Sampling	Ballroom C

Mike Albino, NY
Sandra Peterson, OR
Greg Morris, MI
John Hill, IN
Suzy Whitehead, NM
Tallie Tolen, NM
Sonia Greve, NM
Christina Baltas, MN
Larry Charny, NY
Barbara Neely, OR
Gary Lewis, MN
Shane Dennis, MN

PERM Audits	Ballroom H
Medical vs. Education	Ballroom D
Section 504 in Schools	Ballroom G
Billing on Your Own	Ballroom E



The Challenges of Rural and Urban District SBS Programs

This program will use a combination of lecture and interactive styles that provide two perspectives of the Medicaid School-Based Services Program--that of Rural and Urban. From the rural point of view, Martha Ritter will identify challenges unique to her rural Minnesota school districts and describe the methods they used to reduce risk and enhance their district's ability to access reimbursement. She will share some experiences and challenges of rural co-ops, education districts and other member districts including: low incidence populations, the challenge of new policy and paperwork requirements, strategies used to maximize effort, collaborating with outside agencies, and determining how to best utilize the Medicaid reimbursement.

The urban perspective, presented by Larry Charny who is a contractor for the New York City School system, will provide attendees with a distinct contrast to the issues faced by rural school districts. Just the differences in size, as translated in numbers of children, numbers of staff, volume of documentation via paper or computers, will prove to be enlightening. Added to those are the significance of unions, greater impact of immigrants, staff turnover and student and family transience in and out of the system and between schools. All these factors make for unique challenges and solutions that Larry will share.

Location: Greenway Ballroom A-2nd Floor

Speakers: Martha Ritter, SWWC Service Cooperative and Montevideo Area Special Education Service Center, MN
Larry Charny, The Charny Group, NY

Developing Tools to Document Services-Two Experiences

This session combines the efforts by two entities--Chicago Public Schools and the State of Iowa-- to assure the integrity of documentation procedures of Medicaid School Based Services by clinicians and staff in their respective jurisdictions. Both have developed tools that serve primarily as internal audit systems.

The philosophy at Chicago Public Schools (CPS), regarding the delivery of health services is: "a service not documented is a service that was never delivered." Keeping that philosophy in mind, CPS implemented a new internal audit initiative in 2006. This review process is designed to identify potential audit issues or errors by clinical staff prior to a State or Federal review of its Fee-for-Service program. The session will outline a variety of processes that the district has implemented to review services, correct potential errors and communicate issues to staff. The session will also describe the district's response to both Federal and State reviews. Part of the session will be structured in order to solicit lessons learned from other federal, state or LEA attendees. Presenters will also share their recent experiences of the periodic PERM (federal level) reviews as well as a review by the State Office of Inspector General.

The Iowa Dept of Education staff have recently developed a tutorial for training staff in districts on proper documentation requirements. This tutorial also addresses policy and coverage questions. The Iowa portion of this presentation will share how the tutorial was developed and provide insight to other states on a possible solution to training staff on documentation of services.

Location: Greenway Ballrooms E/D-2nd Floor
Speakers: Ann Herrick, Chicago Public Schools, IL
Peter Giles, Public Consulting Group, IL
Terry Murphy, Chicago Public Schools, IL
Dann Stevens, Iowa Department of Education, IA

Staff and Parents Influence Success

This program demonstrates how a local school district's Special Education Parent Advisory Council (PAC) is involved and takes the initiative to gain parental support for the District's efforts to secure Medicaid reimbursement. Staff and a parent from the White Bear Lake School District will describe their strategies for success, the ways they report revenues and expenditures to the PAC members, and how their district utilizes Medicaid reimbursement based on the PAC's priorities. The presentation will also include pictures of students using equipment and materials purchased with Medicaid reimbursement.

Location: Greenway Ballroom J-2nd Floor
Speakers: Dr. Barbara Burke, White Bear Lake School District, MN
Ken Nitsche, White Bear Lake School District, MN
Trina King, White Bear Lake School District, MN
Sandy Douglas, White Bear Lake School District, MN

Bridging the Understanding of School District Internal IDEA Audits and Medicaid Fee-for-Service Programs-One District's Experience

In 2006, Miami-Dade County Public Schools underwent an extensive internal audit of its special education program. During this audit, internal auditors attempted to bridge the services listed on students' IEPs with services that had been billed to Medicaid through the fee-for-service program. At one point in this process, they reached the conclusion that if the services were not billed to Medicaid, the services were not provided to the students per the IEP. This session will share what was learned during this process, give others insight into how they can educate both internal and external auditors during the audit process, and prepare documentation and information in advance of such audits to bridge the gap of understanding of IDEA and Medicaid requirements and processes.

Location: Greenway Ballrooms D/E-2nd Floor
Speakers: Terry Reyes-Gavilan, Miami-Dade County Public Schools, FL
Anne Glass, Maximus, FL

Billing for Medicaid School Based Services on Your Own

This session reviews the development and implementation of an electronic claims submission system that simplifies billing for Medicaid services and eliminates the need for contracting with a billing vendor. Attendees will learn about the journey from the initial efforts to initiate Medicaid billing for Minnesota schools, to development and implementation of software that streamlines data collection, uses EDI standards to eliminate the need for billing vendor contracts, and allows districts to submit claims directly to the Medicaid agency. Participants will gain an understanding of: 1) the history of Medicaid billing in Minnesota that led to the development of a computerized billing solution; 2) the advantages of a web-based data collection system vs. a fax-paper-to-billing vendor process; 3) the time and cost saving advantages of having local control over the data collection process; 4) how claims are submitted directly to state payers using HIPAA EDI 837 health care claims; 5) how districts electronically receive and process HIPAA EDI 835 health care claim payments (i.e.: electronic RAs); and 6) the reporting and auditing advantages of electronic claims processing.

Location: Greenway Ballroom A, 2nd Floor

Speakers: Gary Lewis, Ed.D., Northfield Public Schools, MN
Shane Dennis, President, SpEd Forms Inc., MN

Medicaid Administrative Claiming Maintenance and Sustainability

To facilitate and promote information sharing across the country, this panel of representatives from various states will provide brief overviews of their Medicaid School Based Services Administrative Claiming programs. Of particular emphasis for this session will be how states have resolved the difficulties frequently encountered with this program. Reviews by CMS of the time study methodology, participant compliance, continuity in reporting activities and other current issues will be discussed. Attendees will learn about the successes, similarities and differences that exist around the country in the various Medicaid School Based Services programs that will be represented.

Location: Greenway Ballrooms F/G-2nd Floor

Speaker: Barbara Neely, Multnomah Education Service District, OR
Liz Touhey, California Medicaid Department, CA

Best Practices in Preparing for an Audit

This session will assist providers in being prepared for a Medicaid audit. The presenters will discuss best practices for developing your Medicaid School Based Services program, in anticipation of future audits. The presenters will bring first hand knowledge of experiences from two major urban school districts on the audit process. Participants will learn how to get started, including organizing your data and documents prior to an audit. The program will also help you identify necessary steps to prepare for the auditors and summarize and describe strategies and tips in preparing for an audit.

Location: Greenway Ballrooms E/D-2nd Floor

Speakers: Janet Lowe, Saint Paul Public Schools, MN
Kay Dole, Minneapolis Public Schools, MN
Elizabeth Jurgens, Public Consulting Group, IL

Cost Effectiveness of School-Based Health Centers

This session presents an analysis of the cost-effectiveness of school-based health centers (SBHC), student health-related quality of life, and total health care expenditures for students that use a SBHC. The Health foundation of Greater Cincinnati funded eight SBHCs in the greater Cincinnati area in order to increase health care accessibility for students in these communities. This analysis examines the link between overall health service utilization based on Medicaid total costs and SBHC encounters for eligible students to assess improvements in

health-related quality of life by comparing students using the SBHC with students who didn't use the SBHC and students in comparable school districts without SBHCs. Data from both the HFGC Health Outcomes Study and the HFGC funded SBHC Cost Study of the Greater Cincinnati area are combined to address these issues.

The Health Outcomes Study is a 3-year longitudinal study to examine how the presence of an SBHC influences students' health-related quality of life, health care access and utilization, health insurance status, and school absences.

Location: Greenway Ballroom J-2nd Floor

Speakers: Jeff J. Guo, PhD, University of Cincinnati Medical Center, OH
Terrance J. Wade, PhD, Brock University, Ontario, Canada

Parental Perspectives Improve Consent Procedures

Third party billing ought to be a good method for schools to receive Medicaid reimbursement for a portion of their costs of serving the needs of children with disabilities. This presentation will highlight issues in third party billing from the parent perspective and offer illustrations of best practices as well as barriers to success. Participants will be invited to join the discussion concerning possible solutions to the problems inherent in billing Medicaid for school based services.

The material will include parent perspectives of Medicaid billing with an examination of the reasons for parental confusion and apprehension about providing consent. Illustrations will be provided and discussed which demonstrate best practices in using Medicaid reimbursement to help defray some of the costs of assistive technology for children with disabilities. It will also underscore problems which give rise to barriers in implementing best practices. The program will also briefly review current federal and state statutes and regulations as well as provide information about Minnesota's programs, unique features, and common and best practices concerning Medicaid billing.

Location: Greenway Ballrooms B/C-2nd Floor

Speakers: Amy Dawson, Health Advocacy Center and Family Voices of Minnesota
PACER Center, MN

Connecting the Work of State Agencies

This session will provide an overview of the Minnesota System of Interagency Council (MnSIC) and discuss implications for a systems approach to coordinated services for students with disabilities and their families. Minnesota statute established this interagency group of seven state agencies (i.e. Commerce, Corrections, Education, Employment and Economic Development, Health, Human Rights and Human Services) along with the Association of Minnesota Counties, Minnesota School Boards Association, Minnesota Administrators of Special Education, and the School Nurse Association of Minnesota.

The primary charge of the council is to identify and assist in removing barriers to local coordination of services provided to children with disabilities and identify adequate, equitable and flexible funding sources to streamline services. The presenters will provide the Council's strategies for delivering positive outcomes for children and families in their state.

Location: Greenway Ballroom A-2nd Floor

Speakers: Lola Jahnke, Minnesota Department of Health, MN
Robyn Widley, Ed.S., Minnesota Department of Education, MN

Medicaid and School-Based Health Centers-Building Bridges

This session will discuss the various roles of school-based health centers (SBHCs), particularly as they operate in New Mexico's health care delivery system. It will also suggest strategies for developing partnerships between SBHCs, state agencies, and Medicaid managed care organizations (MCOs) to generate reimbursement for SBHCs. The program will describe the steps that the New Mexico Medicaid program has taken to integrate SBHCs into its network of primary and behavioral health care providers, provide suggestions attendees can use to develop best practices and protocols for services and collaboration, and propose ideas to increase the long-term viability of SBHCs as part of your state's mainstream health care delivery system.

Both presenters have extensive experience in conducting successful talks, discussions, presentations, and trainings, both on national and local levels. Individually, and frequently in partnership with each other, the presenters have been invited to conduct breakout sessions at a wide variety of meetings, including the NAME 2004 and 2006 Annual Conferences, the National Assembly for School-Based Health Care, and New Mexico's Head to Toe Conference. This presentation will engage audience members, respond to their questions, and provide replicable tools that can be used in other states and programs.

Location: Greenway Ballroom J-2nd Floor

Speakers: Tallie Tolen, New Mexico Human Services Department, NM
Suzy Whitehead, MSN, RNC, New Mexico Human Services Department, NM

PERM Audits-What are They and How do they Impact SBS?

This session will provide an overview and insights to assist providers in being prepared for CMS's Medicaid Payment Error Rate Measurement (PERM) audits. The presenter will provide an overview of PERM, how CMS is currently conducting the audits, how PERM is impacting schools and Minnesota's experience with PERM for Federal Fiscal Year 2006. The presentation will assist school Medicaid providers to take the steps necessary to be PERM-ready. The presenter will bring first hand knowledge of experiences in working with PERM audits and schools. Attendees will leave with an understanding of the PERM national initiative and how it impacts them as Medicaid-enrolled school based services providers, as well as provide suggestions so school clinicians and staff can be PERM-ready.

Location: Greenway Ballrooms F/G-2nd Floor

Speakers: Christina Baltus, RN, BSN, PHN, MA, QMRP, Minnesota Department of Human Services, MN

Demonstration Project for Children with Fetal Alcohol Spectrum Disorder (FASD): A New Model for Community Service Delivery

Alaska is in the planning stages of a five-year Medicaid Demonstration Project for youth in residential psychiatric treatment centers (RPTCs). As one of only ten states awarded this opportunity by the Centers for Medicare and Medicaid Services (CMS), Alaska will be implementing new home and community based services under the familiar waiver format to a select group of youth in October 2007. The Project's goal is to reduce the number of youth, ages 14 to 21, in RPTC's who are Severely Emotionally Disturbed (SED) and have Fetal Alcohol Spectrum Disorder (FASD) through individualized, culturally appropriate, effective interventions delivered as close to home as possible.

Participants will learn about Alaska's innovative approach to building natural and paid supports in its communities for this very difficult-to-serve population. Their unique service delivery model works to bridge the gaps between mental health, school-based services, developmental

disability and mental retardation systems. Differences between regular Medicaid services and waiver services will also be clarified within the context of this demonstration project.

Location: Greenway Ballrooms H/I-2nd Floor

Speaker: Michelle Lyons-Brown, Alaska Department of Health and Social Services, AK

Membership Discussions

With the release by CMS of Proposed Rule 2287, the focus of the NAME Membership Discussions has been modified to reflect the times. The NAME organization still recognizes that the three different membership categories might address life after 2287 differently. We would like your feedback on the following three questions as we contemplate the best way for our organization to respond during the public comment period, as well as plans for the future.

- Question 1 for discussion: How does CMS 2287 on the elimination of Administrative Claiming and Transportation reimbursement effect your specific group (State, LEA or Vendor)?
- Question 2 for discussion: How do you and your agency/company plan to respond to this action by CMS?
- Question 3 for discussion: How would you like the NAME organization to partner with you to respond to this action by CMS?

This information will be reviewed and summarized for sharing on Friday morning with all conference attendees, along with the NAME Board on Friday afternoon.

	Location:
State Attendees	Greenway Ballroom I
LEA Attendees	Greenway Ballroom D/G
Vendor Attendees	Greenway Ballroom J
Other Attendees	Greenway Ballroom B



Annual Meeting

All conference attendees become members of NAME for the 2008 membership year. This is your opportunity to attend the annual membership meeting and get up-to-the-minute year end reports about what the Board of Directors and committees have been engaged in during the past year. Find out what the plans are for the upcoming year. In addition, the slate of candidates for elected positions is presented and members have an opportunity to study the candidates and obtain additional information before voting members elect officers and members of the Board of Directors.

Location: Nicollet B/C-1st Floor

Recent State Plan Amendment Experiences

To facilitate and promote information sharing across the country, this panel of representatives from various states will provide brief overviews of their recent experiences in submitting a Medicaid State Plan Amendment (affectionately known as SPA) that impacted their School Based Services Fee for Service Program. Attendees will come away with a better sense of where similarities and differences exist in this process.

Location: Greenway Ballrooms F/G-2nd Floor

Speakers: Michelle Lyons-Brown, Alaska Department of Health & Social Services, AK
Nora Poisella, North Carolina Department of Human Services, NC
Tracy Brunner, Ball State University, IN
Kathy Cummins Merry, Wayne County RESA, MI
Sally Nadolsky, Iowa Medicaid Enterprise, IA



Mike Albino is currently Director of the Bureau of Revenue Initiatives in the Office of the Medicaid Inspector General of the New York State Department of Health. He began his State career working for the Office of the New York State Comptroller, and for the past 30 years has worked for the audit agency responsible for overseeing Medicaid reimbursement in New York State. His duties shifted from auditing specific providers to special projects focused on securing federal Medicaid reimbursement which resulted in his current involvement with NAME. He is a charter member of NAME and has served on the Board of Directors as the Region II representative. He has an undergraduate degree in accounting from Siena College and an MBA in Health Systems Administration from Union College.

Christina Baltes' current role is the Federal Health Care Audits Manager with the Minnesota Department of Human Services. Her responsibilities include managing the federal Payment Error Rate Measurement Program (PERM). Prior to joining the Minnesota Department of Human Services, Christina had a sixteen year tenure with the Minnesota Department of Health which included approximately two years as the Staff Education Specialist with the Case Mix Review Program; five years as a health facility surveyor and nine years as an investigator with the Office of Health Facility Complaints- all in the Division of Compliance Monitoring. Christina is also currently enrolled in a doctorate program at Hamline University in St. Paul, Minnesota.

Brenda Mack-Bowman, NAME, Inc. 2007 President has more than 32 years of experience in state government. She is an Education Specialist with the Delaware Department of Education managing the statewide school-based health services cost recovery efforts. She manages a team of thirteen cost recovery staff located throughout the state. Brenda has been involved with NAME since its inception.

Ms. Mack-Bowman's previous experience was with the Delaware Office of Management and Budget as a Senior Fiscal and Policy Analyst. She worked with several state agencies in the development of their strategic plans and performance measures. She made budget recommendation on both the operating and capital budgets. She also performed management efficiency studies and provided statewide training in management techniques for the State of Delaware, Personnel Office. Ms. Mack-Bowman has a Masters in Business Administration and is seeking a Doctoral degree in Education, ABD.

Michelle Lyons-Brown came to Alaska 26 years ago to teach in the village of Shishmaref. She spent 14 years in the Arctic before moving to the capital city of Juneau. For the past 17 years, she has worked for the Department of Health and Social Services determining Medicaid eligibility, providing child protective services as a licensed social worker and most recently developing policy and conducting federal negotiations for the state's Medicaid program. She was the primary negotiator of the recently approved School-Based Administrative Claiming Plan and was instrumental in developing and implementing the state's School-Based fee-for-service policy. Michelle is also the state's Olmstead Coordinator and the current Project Director for

Alaska's Home and Community Based Medicaid demonstration project for children in Psychiatric Treatment Residential Facilities.

Tracy Brunner is a research and public policy analyst for the Indiana Education Project at Ball State University. She works closely with the Indiana Department of Education, Division of Exceptional Learners on school-based Medicaid claiming. Previously Ms. Brunner worked for 20 years at the Indiana Medicaid agency, where her program management responsibilities included serving as the Medicaid State Plan Coordinator.

Barbara Burke, Ed.D. is the Supervisor of Special Services for the Duluth, Minnesota Public Schools. She just began this position in August 2007, and she is responsible for planning, coordinating and supervising special education and related services and facilitating interagency coordination of services. Dr. Burke most recently was at White Bear Lake Area Schools in Minnesota where she served as Director of Special Services. She holds a doctoral degree in Educational Leadership from St. Thomas University as well as a Master's Degree in Special Education. Barbara has provided private educational consulting services and has worked for Northeast Metro District 916 as well as the Minnesota Department of Education. She is well respected as a Special Education Administrator in Minnesota. Barbara and her husband, a retired educator, have recently made Duluth their home.

Lawrence B. Charny, has served in various capacities as administrator and supervisor of special education programs since 1979, having begun teaching in NYC's Bellevue Psychiatric Hospital. Currently, he is President of the recently formed consulting company, The Charny Group, LLC. Mr. Charny is consulting Director of the Medicaid Special Projects Unit in the Office of the Auditor General for the New York City Department of Education. He is charged with performing reviews of processes, controls, and documentation to support claims for Medicaid-eligible services; the design, implementation and testing of corrective action plans and reviews; and assisting the Department and its legal counsel in the collection, interpretation and verification of documentation to be submitted in response to federal and state audits and reviews. He has served in this position for over five years, having been recruited by the NYCDOE to assist in its response to the Federal HHS/CMS audit of Medicaid claims for special education health-related services. Mr. Charny is the co-chair of the Communications Committee of NAME and is on the executive committee of the Council for New York Special Education Administrators. He presented at two national conferences recently: the May 2007 LEAnet conference in Washington DC, and at the August 2007 Council of New York Special Education Administrators.

Mr. Charny holds a M.A. in Communications from New School for Social Research and a M.A. from New York University in Educational Administration and Supervision. He received his B.A. from Brooklyn College and has done doctoral work at the University of California at Berkeley. Mr. Charny's long term goals are to make school-based Medicaid claiming pleasant and to complete his book on the impact of Marlon Brando's acting style.

Amy Dawson is a parent advocate at the PACER Center, where she is the Coordinator for the Health Advocacy Center and Family Voices of Minnesota. Amy practiced law for nearly 12 years and her practice included helping clients receive long-term disability benefits. She also taught sports and recreation law at the University of Minnesota. Amy has made presentations to large and small audiences of parents and professionals. Amy is the parent of four year old twins, one of whom has multiple disabilities and uses assistive technology.

Shane Dennis is President and owner of SpEd Forms, Inc. Shane has helped hundreds of school districts to implement special education database and billing systems. He is scheduled to

speaking at least fifty days each year to support groups, teachers and school committees for both training of his software and updates.

Kay Dole is the coordinator of the Third Party Medicaid Reimbursement program for Minneapolis Public Schools. Kay is a Licensed Occupational Therapist with both education and medical management experience. She is currently chairperson of the Minnesota State Leadership committee on Third Party Reimbursement. Kay has numerous publications related to International adoption.

Sandy Douglas has worked for the White Bear Lake School District for twenty years, and during the last eight years, served as the Third Party Billing Secretary. She has an Associate Degree from Rasmussen Business College in Clerical, Secretarial and Office Management. Sandy is married and has four children. She also has been teaching fitness classes at the local YMCA for the last 21 years.

Peter Gilles is a Senior Consultant with Public Consulting Group, located in Chicago. Mr. Gilles has over ten years experience in public sector work, with his focus being special education and school-based Medicaid reimbursement experience. He has negotiated programs in the states of Nebraska, Illinois, Michigan and Texas, in the administrative claiming and fee for service billing programs. He has also coordinated work and reviewed procedures for school-based projects in the states of California, Florida, Georgia, North Carolina, Ohio and Tennessee. Mr. Gilles currently manages Administrative Claim Program and Fee-for-Service programs for Chicago Public Schools, the Administrative Claim Programs for the State of New Jersey and the State of Kansas, as well as coordinating the financial data collection and quality review process for all of the school districts in Michigan.

Anne Glass, The Miami-Dade County Public Schools contracts with MAXIMUS to serve as its Medicaid Cost Recovery Agent. Anne Glass serves as the Project Manager on this project. Ms. Glass, a senior manager with MAXIMUS, has over 20 years of experience with Medicaid programs, having served as the Florida Department of Education's Medicaid consultant and a health care/program analyst with the Florida State Medicaid agency. Ms. Glass, a former public school teacher, also has served as the President/CEO of a nonprofit federally-funded Community Health Center, and Executive Director of an Association for Retarded Citizens. Ms. Glass currently serves as a project manager for assisting the Mississippi Department of Education, Miami-Dade Public Schools, and numerous Florida school districts in participating in Medicaid.

Sonia Greve has worked in the New Mexico Medicaid industry for over 8 years. Her broad range of experience includes working directly with providers and their billing staff and serving as a liaison between New Mexico Medicaid and its fiscal agent. She is currently a management analyst for the NM Medical Assistance Division School Health Office (SHO). Sonia oversees school based administrative claiming and is a key source for technical assistance for direct services policy and billing

Cathy Griffin has over 36 years experience in working with public assistance programs and 22 years specifically developing programs and services for people with disabilities. She has been employed in a variety of settings including county and state human service agencies, a non-profit health system, a for-profit home health agency, and her own health care consulting and event planning organization. In 1997, together with School District #622 and a grant from Children, Families, and Learning, she developed a basic model for billing health related services that can be adapted to the unique needs of each district. That model became known as the SCHOOL Project and is currently providing support and billing management services for over twenty districts in Minnesota. In 2001, Cathy returned to public service at the MN Department

of Education where she is the Third Party Reimbursement Policy Specialist, and also provides support to nursing in Special Education and is the department expert on HIPAA related issues. She holds a Bachelor of Science Degree in Speech Communication from the College of St. Catherine and is a member of Lambda Pi Eta.

Jeff Guo is an Associate Professor of Pharmacoepidemiology and Pharmacoeconomics at the University of Cincinnati (UC) College of Pharmacy and a Research Fellow of the Institute for the Health Policy and Health Services Research at the UC Medical Center. He has been teaching graduate courses, Pharmaceutical Economics & Policy, Pharmacovigilance, Research in Pharmacoepidemiology & Drug Safety and Biostatistics for Pharmacist at UC, and has served as major advisor for several PhD, MS, and PharmD students. Prior to joining UC, he worked as a Drug Information Specialist at the United States Pharmacopeia in Rockville, Maryland; as a research manager of pharmacoepidemiology & pharmacoeconomics at the Degge Group, in Arlington, Virginia; and as a project manager at the China National Drug Administration and the China National Economic & Planning Commission. He is a founder and the most recent chair-elect for the International Society for Pharmacoeconomics and Outcomes Research (ISPOR) Asian Consortium Advisory Committee. He has extensive project experience with Ohio and Alabama state Medicaid drug utilization reviews and health policy research, Pharmacopeia Drug Information, and the national medication error report system (MedMARx®). He has had contract research experience with major pharmaceutical companies such as Bristol-Myers Squibb, Johnson & Johnson, AstraZeneca, and Pfizer. He has numerous peer-reviewed publications in pharmacoepidemiology and pharmacoeconomics on topics including a physician prescribing behavior, diabetes associated with antipsychotics, cisapride and contraindicated medications, acute pancreatitis associated with antiretroviral medications, drug-induced hepatotoxicity, cost-of-illness analysis for diabetes, a cost-benefit analysis for asthmatic medications, the measurement of quality in the practice of oncology, the costs to business of HIV/AIDS, drug control policy, drug price and market competition, as well as an evaluation of health outcomes for children who use school-based health centers.

Ann Herrick is an Administrator with Chicago Public Schools, has worked with its Office of Specialized Services and more recently with its Office of Finance. Her responsibilities have included oversight over the Health Services Management Program in 1995-2003 as well as review and guidance on the Medicaid claim processing, program audit reviews and policy analysis relating to Medicaid, SCHIP, IDEA and other federal programs from 1993 to date. Ms. Herrick has participated in school-based Medicaid conferences organized by N.A.M.E., Council of Great City Schools and LEAnet. She has collaborated closely with the Illinois Department of Healthcare and Family Services, the Illinois Board of Education as well as other school district and state officials in Illinois and elsewhere.

John Hill has over 33 years of experience working with and on behalf of individuals with disabilities. For five of those years he served as the program manager for Indiana's Home & Community-Based Services waiver for persons with Developmental Disabilities, and for two years he was the Indiana State Director for the Bureau of Developmental Disabilities. Since 2000 John has been with the Indiana Department of Education in the Division of Exceptional Learners. At the DOE, among his current responsibilities, he serves as the Division's Medicaid liaison. John has served two years as the chairperson for the Indiana Commission on Rehabilitation Services and continues to represent the DOE on the Commission. John also currently is the Secretary for LEAnet, which is a national organization of local public school districts /corporations.

The LEAnet's primary focus is protecting and enhancing funding for public school health programs and services. John is a past President of the National Alliance for Medicaid in Education and current chair of the NAME Governmental Affairs committee.

Bruce Hunter Associate Executive Director for Governmental Relations, American Association of School Administrators came to AASA in 1982 as a Legislative Specialist. He became Director of Governmental Relations in 1986. During that time AASA has developed a large, active legislative corps that has facilitated school administrators' influence on federal policy and legislation.

Bruce received a B.A. from the University of Northern Colorado, an M.A. from the University of Texas at El Paso and did graduate work in education administration at the University of Colorado.

Prior to joining AASA, Bruce taught at both the secondary and collegiate levels. He also trained Head Start teachers, and was a grant administrator for the Education Commission of the States. Bruce was born and raised in Wyoming, and held positions in Wyoming, Colorado, New Mexico and Arizona before coming to AASA.

Lola Jahnke Public Health Social Work Specialist, Community & Family Health, Minnesota Department of Health, graduated from Mankato State College with a Bachelors degree in Social Work and the University of Michigan with a Masters in Social Work. She is employed with the MN Department of Health as a Public Health Social Work Specialist in the MN Children with Special Health Needs program and is involved with numerous activities to support the Interagency Coordinated System for Children with Disabilities. She also coordinates the statewide Follow Along Program (FAP), a tracking and monitoring program from children birth to three at risk of health or developmental needs.

Elizabeth Jurgens is with the Public Consulting Group, Inc. in Chicago and is currently the Project Manager for such school districts in Minnesota as St. Paul Public Schools and Minneapolis Public Schools, as well as the Project Manager for the School District of Philadelphia's IEP and Medicaid Implementation Team. Ms. Jurgens has over ten years of School based Medicaid experience and has experience in implementing web-based IEP systems and Medicaid programs across multiple state projects and has managed cost reporting & analyses for reimbursement opportunities and enhancements. Ms. Jurgens has a Bachelor of Arts and is currently obtaining her MBA.

Trina King is a School Psychologist and Medicaid/Third Party Billing Specialist for the White Bear Lake School District in White Bear Lake Minnesota. She graduated from SUNY at Oswego where she earned her BA In Psychology and attended SUNY at Albany where she earned her Masters in Educational Psychology. She earned a Masters in Education from U of W, Riverfalls. She is a licensed psychologist. Trina has worked at the White Bear Lake School district for 19 years, has been married for 33 yrs and has two adult sons.

Tricia Krotenberg, MBA, M.Ed, has a bachelor degree in Health Administration and Masters Degrees in Business Administration and Education. She has over 18 years of experience in the health care field. Ms. Krotenberg currently works for the Arizona Medicaid agency, AHCCCS (Arizona Health Care Cost Containment System), and is one of the Program and Policy Managers for the Medicaid School Based Claiming (MSBC) program. Having significant experience with the administrative and operational requirements of medical offices and clinics, and in particular, navigation through the often complex requirements of fee reimbursement for medical service providers and facilities, she is uniquely qualified to understand the complex nature of school based claiming. Through her education credentials, she has an appreciation for how school districts must comply with the MSBC program requirements.

Gary Lewis, Ed.D. has degrees in Special Education Administration from the University of Northern Colorado, School Psychology from the University of Wisconsin - Eau Claire and his MS in Guidance and Counseling from the University of Wisconsin - Stout, and Psychology and

English. Gary chaired the committee establishing Medicaid billing for Minnesota schools. He has presented at regional, state and national conferences and testified before the Minnesota Senate and House school finance committees. He is a member of the board of the MN Council for Exceptional Children and a past president of the MN Administrators for Special Education.

Janet Lowe is the coordinator of the Third Party Medicaid Reimbursement program in Saint Paul Public Schools. Janet is a Licensed School Nurse and Pediatric Nurse Practitioner. She has published articles and chapters related to the School Nurse's Role in the Special Education Process and Third Party Reimbursement on a national level.

Kathy Cummins Merry is the Executive Director of Medicaid Reimbursement for Wayne County Regional Education Services Agency (RESA), the first district in Michigan to enroll and begin billing Medicaid for the School Based Services Program in 1994. Wayne RESA has over 300,000 school children including Detroit Public Schools. She is a member of the NAME Board of Directors representing LEAs, serves as the President of the LEAnet, is a member of Michigan's Medicaid Advisory Board of Intermediate School District Superintendents and numerous other boards dedicated to helping children. Kathy also serves as the Wayne RESA lobbyist covering education and Medicaid issues both at the state and federal levels.

Greg Morris has practiced public policy law for more than thirty years, specializing for the past dozen years in special education and Medicaid reimbursement for schools. He is the pro bono counsel for NAME and serves as the LEAnet Coordinator. Mr. Morris' clients have included six school billing companies, the State of Wyoming, the New Mexico Coalition of School Administrators, a state-wide coalition of Ohio LEAs, and several other state and local entities. He is a frequent presenter at state-wide and national events, including the past two NAME conferences.

Terryn Murphy, Chicago Public Schools, Manager, Health Services Management Program. In the course of a diverse 7-year career in corporate and government technology services, Terryn Murphy has proven to be a skilled professional with a passion for developing user-friendly technology solutions. Immediately following her collegiate experience, Terryn joined leading consulting firms including KPMG Consulting and Arthur Andersen within their web development and data management teams. Terryn later joined Chicago Public Schools in 2004 and served as Compliance Manager for the Office of Specialized Services, which represents over 55,000 students with disabilities. In this role, Terryn was responsible for monitoring the delivery of student services outlined in their Individual Education Plans (IEP). Currently, Terryn leads the Health Services Management Program (HSMP) for the Office of Specialized Services. HSMP is a management and accountability system designed to ensure the delivery, documentation and monitoring of health-related services to all children of the Chicago Public Schools.

Terryn holds a Bachelor of Science from the University of Illinois at Urbana where her degree is in Business Administration with a Management Information Systems concentration.

Sally Nadolsky, LISW, is a Medicaid policy specialist for children's programs in the Iowa Medicaid Enterprise. In this position Ms. Nadolsky has been responsible for policy in both the School Based and the Medicaid Administrative Claiming programs. Ms. Nadolsky has been with the Iowa Medicaid program for 16 years.

Barbara Neely, RN, BSN, MPA, NCSN, has earned her Bachelor of Science degree in Nursing from Oregon Health Sciences University, a Masters' degree in Public Administration and Health Policy from Washington State University, and she is a Nationally Certified School Nurse. Currently, Barb is Director of the Department of Health and Social Services for Multnomah

Education Service District. Barb has been in the field of school health for twenty years. She has been the coordinator for eight school districts for the School Based Health Services program since the initiation of Oregon's Medicaid State Plan in 1990. Barb is also the coordinator of those districts' Medicaid Administrative Claiming since its roll out in Oregon in 2002.

Ken Nitsche is the CEO of Waivered Services, Inc. A flexible Case Management company working with families with Developmentally Delayed Children.

Kenneth earned a Bachelors degree in Human Services and served as an advisor to the former Masters in Developmental Delays at St. Mary's College. He currently serves on the board of directors of MACMH (Minnesota Association for Children's Mental Health). Kenneth is also co-founder of Sheltering Lodges a Native American provider serving persons with the DD Waiver (formerly the MR/RC Waiver) and Elderly Waiver. Along with his wife they have spent 20+ years doing foster care for children with Developmental Delays. They have four biological children and have adopted five of their foster children.

He has been involved with the White Bear Lake schools for over 35 years. Kenneth has worked with the Special Education department of White Bear Lake to supplement the special education budget with Third Party Reimbursement moneys, and served on the advisory committee which oversees the priorities for expenditures of the Third Party Reimbursements

Sandra Peterson, RN, is currently a Medicaid Supervisor in the Multnomah Education Service District in Portland, Oregon. She began there in 2003 and since then has updated and upgraded the School Based Services (SBS) program to comply with the HIPAA technology, privacy and security requirements. Prior to her current position, she spent 15 years at the Oregon Department of Human Services, Office of Medical Assistance Programs, where she deployed Medicaid programs for the Office of Mental Health and the Oregon Department of Education, implementing new programs within those agencies. From 1996 to 2005, Sandra contracted with a non-profit education-based statewide consortium of Oregon Public School Districts participating in the Medicaid SBS reimbursement program as well as the Alaska Governor's Council on Disabilities and Special Education to explore public school reimbursement through Medicaid.

Sandra's work with county mental health providers helped them more effectively utilize technology, and through demonstration grants she wrote, they were able to comply with Medicaid requirements. Sandra also worked with the Oregon Academy of Audiologists to bring compliance and technology efficiencies to the industry. She has developed accountability software for non-profit health and human service organizations and local governments who desire to measure outcomes and effectiveness, and report program impact to one or more funding sources.

Nora Poisella worked 8 years at Governor Morehead School for the Blind in Raleigh NC. At the school was Director of Comprehensive Clinic/Dietary Services responsible for the planning, administration, supervision and coordination of the clinic staff which included a pediatrician, psychiatrist, clinical psychologist, nursing staff, social worker, occupational speech and physical therapists as well as dietary department, where she managed the medical and educational records and was responsible for all compliance issues. Ms. Poisella has worked 8 years in the North Carolina Division of Medical Assistance (DMA) and currently is a Local Education Agency (LEA) Program and Independent Practitioner (IP) Program Manager. She also currently oversees the prior approval process for all therapy services. Nora is currently a Board member of NAME representing region IV.

Nancy Reder, Deputy Executive Director, the National Association of State Directors of Special Education (NASDSE) has served as NASDSE's deputy executive director and director of

government relations for seven years. She has more than 30 years of experience in providing direct services to vulnerable children and families, policy analysis in human service programs and nonprofit management. As a social policy analyst, she has worked on a broad array of federal legislative and regulatory issues affecting children and families, including families of children with disabilities and family economic issues. Prior to joining NASDSE, Ms. Reder worked as an outreach social worker for Catholic Charities in Detroit, a school social worker in Alexandria, Virginia, director of social policy for the League of Women Voters Education Fund and for the U.S. House of Representatives as a senior staff member of the Select Committee on Children, Youth and Families and on state human services information systems for IBM. Ms. Reder has spoken widely on federal policy affecting children with disabilities and their families.

Ms. Reder received her B.A. and M.S.W. degrees from the University of Michigan and her J.D. from Catholic University of America.

Terry Reyes-Gavilan earned both her Bachelor's and Master's degrees in the areas of Specific Learning Disabilities and Emotional Handicaps. She began her career in 1985 with Miami-Dade County Public Schools (M-DCPS) as a special education teacher. After ten memorable years of teaching, Terry moved into the educational administration realm, first serving as a Staffing Specialist, then becoming an Educational Specialist at the M-DCPS District Office for special education. In this role, working under the leadership of the Assistant Superintendent for special education, Terry implemented and coordinated the district-wide Medicaid Reimbursement Programs (Administrative Claiming and Fee-For-Service); reviewing/revising/monitoring the IDEA federal grant; and collaborating with the Offices of Budget Management and Accounting to develop/maintain budgetary/reimbursable funds history reports. After a return of four years to a special education center school as the Program Specialist, Terry returned to the District Office as the Supervisor for the M-DCPS Medicaid Reimbursement Programs. At this time, she proudly represents M-DCPS, this country's fourth largest school district, as an experienced, professional and congenial administrator. Terry plans, coordinates, organizes and monitors both Medicaid reimbursement programs districtwide. She supervises the budgetary functions, prepares Medicaid related budgetary reports and maintains/allocates Medicaid funds districtwide. Terry's commitment to her district's Medicaid reimbursement programs is proven by her tenacity to provide continuous training to the therapy providers, work collaboratively with families, community agencies and contracted vendors, and provide a hands-on approach when addressing issues/concerns regarding Medicaid in schools. Terry's childhood dream of helping students with disabilities will forever be her reason for her career choices. As the Supervisor for the Medicaid Reimbursement Programs with Miami-Dade County Public Schools, Terry firmly believes she has made the right choice to continue to make a difference for all our students.

Martha Ritter, "home grown" in Minnesota and a graduate of University of Minnesota, is the (Medicaid) 3rd Party Billing Administrator for Southwest/South Central Minnesota Service Cooperatives of Marshall, Minnesota. Working at the Montevideo Area Special Education Service Cooperative in Montevideo, Minnesota, she has been instrumental in assisting most of southwestern Minnesota school districts, cooperatives and outside agencies in the school-based Medicaid reimbursement process since the State law mandated participation that became effective in 2000. Additionally, Martha is a member of the 3rd Party Billing Leadership Committee at the Minnesota Department of Education, and leader and coordinator of the 3rd Party Billing Regional Informational/Support group. She has worked with other cooperatives and school districts throughout Minnesota, advising, training and assisting with setting up procedures and policies necessary for successful Medicaid and third party billing. Martha also is on contract with SpEd Forms, Inc., a Minnesota based software provider for Special Education professionals. She assists with input and implementation of the Medicaid billing software program that is used by school districts throughout the State.

Alice Seagren was appointed Commissioner of the Minnesota Department of Education (MDE) by Governor Tim Pawlenty in July 2004. As commissioner, she is responsible for MDE operations and policymaking for all aspects of K-12 education, implementing the *No Child Left Behind* Act in Minnesota, early learning, libraries, and adult, career and technical education.

Prior to her appointment, she served six terms in the Minnesota House of Representatives. During her legislative career she was Chair of the House Education Finance Committee and a member of the Education Policy, Education Finance, Ways and Means, and Transportation Policy committees. Before winning election to the Legislature, she served on the Bloomington School Board and has been a volunteer in her church and in the community. She is currently a member of the Normandale Community College Foundation Board and Fraser Community Services, an organization providing services to the disabled. On the national level, Commissioner Seagren has served as Chair, Education Committee, National Council of State Legislatures, Assembly of State Issues, reflecting her commitment to education and helping people become self-sufficient.

A graduate of Southeast Missouri State University with a B.S. in Marketing, Commissioner Seagren is married to Fred and has two children, Christina and Greg.

Dr. Vernon K Smith, Health Management Associates is a Principal with Health Management Associates and his expertise is in state and federal health policy, with an emphasis on Medicaid and Medicare reforms. He has extensive experience analyzing and developing health reform proposals, administering programs and representing state agencies with federal and national organizations. At Health Management Associates, Dr. Smith assists state agencies in managed care, long term care and understanding the impact of economic trends and welfare reform on Medicaid enrollment. Dr. Smith has authored reports on Medicaid and SCHIP enrollment trends, the impact of welfare reform on Medicaid, the use of Medicaid as a source of financing in state health programs, and exemplary practices in Medicaid primary care case management programs. He has spoken on these issues before many national and state audiences, including testimony before the U.S. Senate Finance Committee and the House Ways and Means Committee.

Dann Stevens, Program Consultant, Medicaid, Iowa Department of Education
Dann is currently the NAME Treasurer, a Past President of NAME, and Chair of the Long Range Planning Committee. He has over 10 years of experience in the field of Medicaid in Iowa. During the last five years, Mr. Stevens has been a Program Consultant with the Iowa Bureau of Children, Family & Community Services with a focus on Medicaid reimbursement for regional agencies, local districts and the early childhood program. Other professional activities include Chairperson of a national sub-committee for a network of state Medicaid staff addressing HIPAA compliance in 2000 and 2001.

Tallie Tolen has served as Program Manager for the New Mexico Medicaid School-Based Services Program for the past three years. During her time with the NM Medical Assistance Division (Medicaid) School Health Office she has worked collaboratively with education agencies throughout the state to implement a new administrative claiming model. Ms. Tolen also provides technical assistance to School Based Health Centers seeking Medicaid reimbursement in order to increase access to care for youth throughout New Mexico

Liz Touhey is a Branch Manager in the California Medicaid Department, also known as Medi-Cal. She has worked for the Department of Health Care Services for 16 years. Liz began working in Public Health, and is now working in Medi-Cal. Ms. Touhey is on the Board of Directors for the National Alliance for Medicaid in Education, is the NAME President-Elect and

works extensively with counties and schools to help them obtain the reimbursement they are legally entitled to through the MAC, LEA and TCM programs.

Terrance Wade is the Canada Research Chair in Youth and Wellness and an Associate Professor in the Departments of Community Health Sciences and Child and Youth Studies at Brock University. His research employs a longitudinal, multi-disciplinary perspective to investigate the social and structural determinants of child health and development, focusing on life trajectories that lead to a variety of childhood and adolescent outcomes. In this capacity, he has worked on several funded projects both in Canada and the United States that focus on factors that focus on resilience and vulnerability of children for various health outcomes. These include an evaluation of a home-based intervention program for 2-3 year olds, the effect of school-based health centres on health and school absences among elementary children, an evaluation of a therapeutic interagency preschool (TIP) for severely maltreated children, and the examination of predictors and consequences of the stability and change in problematic behavioural profiles among young children. His most recently funded project examines the social determinants of child hypertension.

Suzy Whitehead has been a Registered Nurse for 25 years with a national certification in inpatient obstetrics. She has experience in hospital administration and women's health research, as well as extensive experience working with State and local agencies to improve access to care for New Mexico families. She is currently the Nurse Consultant in the New Mexico Medical Assistance Division (Medicaid) School Health Office (SHO). Prior to working for the SHO, she was the Medicaid Nurse Coordinator for Albuquerque Public Schools where she oversaw the Medicaid Services Unit and was the HIPAA consultant for the APS Health/Mental Health Department.

Robyn Widley, Ed.S, Since the early 1980s Robyn Widley has been a leader in Minnesota and throughout the country regarding interagency efforts for children with disabilities and their families. As program manager for a federally funded model demonstration and rural outreach project and as educational consultant and research associate in the western United States and Pacific Rim, she provided technical assistance and support to numerous programs serving young children with disabilities.

For nearly a decade, she was the Minnesota education specialist for early childhood special education and currently supervises state staff in all areas of the coordinated service system including transition, third party funding and care and treatment for students with disabilities. She has been the primary staff person responsible for oversight of the activities outlined within Minnesota Statute 125A.023 and 125A.027. This legislation requires the development of a statewide coordinated, interagency services system (known as MnSIC) for children with disabilities and their families.



The National Alliance for Medicaid in Education, Inc. (NAME) is a non-profit organization that represents the nation's state Medicaid and Education agencies staff who have programmatic responsibility for administering Medicaid's Administrative Claiming and/or Direct Billing of Health Related Service programs in public schools, as well as Local Education Agencies participating in the Medicaid program.

PURPOSE

NAME has three main purposes relative to Medicaid reimbursement in educational settings that drive our organization:

- Provide leadership;
- Promote integrity, collaboration and success; and
- Facilitate a network to share information.

MEMBERSHIP

NAME is comprised of three basic categories of membership:

- Those individuals employed by or under contract with a State Medicaid or Education Agency and who have responsibility for administering Medicaid Administrative Claiming or Direct Billing of health-related services provided under special education by public schools.
- Those individuals employed by or under contract with a Local Education Agency (public school) who for some or all of their day complete activities that enable their school to access Medicaid Administrative Claiming or Direct Billing of health related services provided under special education.
- Individuals involved with Medicaid in Education who either represent themselves or public or private organizations.

ORGANIZATIONAL STRUCTURE

NAME's business is conducted by a volunteer board consisting of the following elected individuals:

- One state agency member from each of the Center's for Medicare and Medicaid Services (CMS) ten regions and two individuals representing Local Education Agencies; and
- Five officers including a President, President-elect, Secretary, Treasurer, and Immediate Past-President.

For additional information about NAME, including its bylaws, please refer to the NAME web site at <http://www.medicaidforeducation.org/>

2007 Officers

President

Brenda Mack-Bowman, DE

President Elect

Elizabeth Touhey, CA

Secretary

Terrie Belton, GA

Treasurer

Dann Stevens, IA

Immediate Past President

Cathy Griffin, MN

Past Presidents and Conference Locations

	Denver, CO	2003
Dann Stevens, IA	Boston, MA	2004
John Hill, IN	Seattle, WA	2005
Cathy Griffin, MN	Indianapolis, IN	2006

2007 Board of Directors and Committees

Board of Directors by Region

I: Denise Achin, RI
IV: Nora Poisella, NC
VII: Vacant

II: Michael Albino, NY
V: John Hill, IN
VIII: Emily Tryer, CO
X: Michelle Lyons-Brown, OR

III: Amy Edwards, VA
VI: Kari Armijo, NM
IX: Melinda Hollinshead, CA

LEA Rep, Kathleen Cummins Merry, MI

LEA Rep: Barbara Neely, OR

By-Laws

Jane Reagan, Chair, MI
Greg Morris, CA
Tom McDowell, FL
Elizabeth Touhey, CA

Web

Michael Albino, Chair, NY
Dann Stevens, IA
Eric Gustafson, OR
Steven Wright, NY

Nominating

Cathy Griffin, Chair, MN
Brenda Mack-Bowman, DE
Sue Robertson, OK
Elizabeth Touhey, CA

Finance

Dann Stevens, Chair, IA
Terrie Belton, GA
Phillip Gonzales, WA
Joseph Greene, FL
Garry Schaedel, VT

Membership

Tricia Krotenberg, Chair, AZ
Christene Bess, WA
Lisa Hill, WA
Bryan Hawkom, MA
Brenda Lenhart, VA
Robin Phillips, GA
Robyn Simental, AZ
Dann Stevens, IA
C. Suzy Whitehead, MN

Communication

Amy Edwards, Co-Chair, VA
Larry Charny, Co-Chair, NY
Denise Achin, RI
Michael Albino, NY
Joseph Greene, FL
John Hill, IN
Barbara Schultz, CA
Emily Tryer, CO

Governmental Affairs

John Hill, Chair, IN
Kathy Merry Cummins, MI
Michelle Lyons-Brown, AK
Gary Tyler, MI
Greg Morris, MI

Long Range Planning

Dann Stevens, Chair, IA
Michelle Lyons-Brown, AK
Greg Morris, CA
Laurie Oyler, MA
Elizabeth Touhey, CA

Research and Education Committee

Cathy Griffin, Tri-Chair, MN
Nora Poisella, Tri- Chair, NC
Dan Courter, NH
Sue Robertson, OK

Barbara Neely, Tri-Chair, OR
Denise Achin, RI
Michelle Macintosh, ND
Linda Sowle, MI

Sandra Peterson, OR
Kari Armijo, NM
Colleen O'Reilly, CA
Jennifer Siemers, WI

2007 Conference

Cathy Griffin, Co-Chair, MN

Teresa Pastore, Co-Chair, MA

Budget and Finance

Dann Stevens, Chair, IA
Kris Jonson, UT
Greg Morris, CA
Teresa Pastore, MA

Charity Auction

Janet Lowe, Chair, MN
Kay Dole, MN
Cathy Griffin, MN
Michelle Macintosh, ND

Communication

Teresa Pastore, Chair, MA
Mike Albino, NY
John Hill, IN
Michelle Macintosh, ND
Jane Reagan, MI
Emily Tryer, CO

Education/Program

John Hill, Co-Chair, IN
Greg Morris, MI
Kris Johnson, UT
Jane Reagan, Co-Chair, MI
Mike Albino, NY
Tracy Brunner, IN

On Site Logistics

Cathy Griffin, Chair, MN
Kay Dole, MN
Janet Lowe, MN
Sophie Oliver, MN
Teresa Pastore, MA



Gold Sponsors

The NAME Conference Committee would like to thank the following nine companies and agencies for their generous support as Gold Sponsors of the Fifth Annual NAME Conference.

We encourage attendees to visit the exhibit areas to thank the sponsors and learn more about their products. NAME does not endorse any of the products or services on display.



Minnesota Department of Education
Special Education Policy
1500 Highway 36 West
Roseville, MN 55113
(651) 582-8200

Department Mission:

Improve educational achievement by establishing clear standards, measuring performance, assisting educators and increasing opportunities for lifelong learning.

Serving approximately:

- 850,000 K-12 students and their families;
 - 122,000 children and youth in special education
 - 118,000 Head Start and Early Childhood Family Education children;
 - 82,000 adult learners in GED and citizenship programs
 - 460 school districts and charter schools;
 - 52,000 licensed teachers
-



The Center for Health Care Financing
UMass Medical School, Schrafft Center
529 Main Street
Charlestown, MA 02129
(617) 886-8200
www.umassmed.edu

The Center is a Massachusetts-based public sector organization that is part of the University of Massachusetts Medical School. The Center provides management consulting and operational services to state and local human services and educational agencies.

The Center works with state and local entities to:

- Design and implement cost-saving strategies and cost-containment projects;
- Design and implement creative initiatives that reduce the overall level of state and local expenditures for human services programs; and
- Identify additional revenues to which they are entitled under federal law.

The Center is solely focused on improving the return of state and local health care dollars. We work in partnership with our clients to serve the public good while keeping a keen eye on the bottom line. We understand the challenges facing state and local agencies because we are also public. Our unique insight into the market, combined with financial expertise, allows us to help public agencies maximize their resources and revenues. We believe in the philosophy of “knowledge transfer”—sharing our experience with our clients and empowering them to provide more cost-effective health care.



ClaimAid Consulting Corporation
5780 West 71st Street
Indianapolis, IN 46278
1-800-842-4052
www.claimaid.com

Experienced

ClaimAid has been helping schools implement and grow their Medicaid direct billing programs since 2002. You have a seasoned partner when you have ClaimAid in your school.

Involved

Our model of training and support is active and engaged. Our technology tools and processes keep your staff focused on services and children, not paperwork and claim submission.

Endorsed

In 2003, the Iowa Association of School Boards selected ClaimAid as the vendor for their IMED program. Our role is to help Iowa schools document and capture revenue for all billable services.



MAXIMUS
11419 Sunset Hills Road
Reston, VA 20190
(602) 751-5858
www.maximus.com

The Educational Services Division of MAXIMUS provides a complete set of management tools for all levels of the educational system. We provide Medicaid cost recovery services, consulting services, educational management software, technical and financial support and software tools for higher educational institutions and not-for-profit organizations involved with federally funded research and other sponsored programs.

TIENET is a single program for managing instruction, assessment and special education that provides three applications that can be used separately or as one coordinated system for:

- * Instructional Data Management
- * Response to Intervention Management
- * Special Education Case Management

MAXIMUS administers two school-based Medicaid programs-

- * Fee for Service Claiming
- * Administrative Claiming

These programs assist participating school districts by reimbursing them for Medicaid covered services provided to eligible and qualified students.

MAXIMUS Consulting Services are led by educators who have held senior leadership positions within educational agencies and support organizations seeking to better manage their educational programs.

MAXIMUS has over 280 offices nationwide and has assisted more than 2,200 school districts in their educational endeavors and has also provided services to more than 100 distinguished colleges and universities in the U.S.



Public Consulting Group (PCG)
148 State Street, 10th Floor
Boston, MA 01209
(617) 426-2026
www.pcgus.com

Public Consulting Group (PCG) offers full-service consulting and innovative, scalable technology solutions to meet the changing needs of the K-12 education community.

- ✓ Web-Based Special Education Management
- ✓ Response to Intervention (RTI) Solutions
- ✓ Medicaid Reimbursement
- ✓ Data Integrity
- ✓ School Improvement Planning



PARADIGM™

Paradigm HealthCare Services
311 California Street, Suite 200
San Francisco, CA 94104
(415) 616-0920
www.paradigm-healthcare.com

Ready for a solution to your Medicaid claiming? Paradigm HealthCare Services has the key. We are a specialized firm who partners with school districts, county offices of education, and local education consortia in the administration of the fee-for-service and Medicaid administrative claiming programs. Since our establishment in 1989, our solutions are proven to maximize participation, alleviate administrative burden, and ensure regulatory compliance. Paradigm brings additional ease to participation by complimenting our consultation and billing services with technological solutions to include a student healthcare case management system and a Medicaid administrative claiming management system. We make it easy for you.



Interface Consulting Group
PO Box 361
Hazleton, PA 18201
(877) 455-7505
www.interfaceconsultinggroup.com

Interface Consulting Group provides a range of consulting services for school-based Medicaid programs including legal, financial, and management matters relating to participation in school-based Medicaid programs. We assist state education agencies and school districts in evaluating Medicaid programs for regulatory compliance, and we provide advice and quality assurance reviews in preparation for a formal audit process. We can also generate and manage compliance plans, provide downstream quality assurance checks, and assist in the preservation of evidence needed for appeals.

Our thorough understanding of federal and state Medicaid laws, regulations, and procedures comes from years of first-hand, professional experience in administering state and local education agency Medicaid programs in multiple capacities, and in the management of federal Medicaid audit and audit review programs, including adjudicating complex disputes over Medicaid funding.



Educational Services & Products LLC
19 Dove Street, Suite 104
Albany, NY 12210
(518) 445-3840
www.espllc.com

During the past five years, Educational Services & Products, LLC (ESP) has become the fastest growing Medicaid Billing Agent for School Districts in the country. During that same period of time, ESP also developed the **Student Tracking And Reporting System™ (STARS™)**, a state-of-the-art, Web-based management information system for School Districts' Special Education programs.

Our underlying philosophy at ESP is to provide only the products and services that each of our client's actually needs. That is why we begin each new business relationship by undertaking a free, on-site evaluation of each School District's current level-of-compliance with all of the applicable requirements of the *Family Education Rights and Privacy Act (FERPA)*, the *Health Insurance Portability and Accountability Act (HIPAA)* and the *Individuals With Disabilities Education Act (IDEA)* – and its current Medicaid claiming procedures. Thereafter, we provide each School District with an "Evaluation Report" that identifies any existing "gaps" or "overlaps" in its current operations – and details what will have to be done in order to resolve those issues.



SpedForms, Inc.
PO Box 1
Jasper, MN 56144
(866)796-1848
www.spedforms.com

SpEd Forms Inc. prides itself in delivering outstanding software, service and support to school districts at the lowest possible cost.

MA Forms, from SpEd Forms Inc., is an inexpensive web-based 837/835 medical batch billing system which enables school districts to electronically collect data and bill directly, eliminating per claim fees.

Silver Sponsors

The NAME Conference Committee would like to thank the following six companies for their generous support as Silver Sponsors of the Fifth Annual NAME Conference:



Health Evolutions
9000 Keystone Crossing Blvd
Suite 200
Indianapolis, IN 46240
(317) 815-0801
www.healthevolutions.com



MedBill Corporation
4801 Willoughby Road
Suite 7
Holt, MI 48842
1-800-279-1395
www.medbill.com



Navigant Consulting
1201 Third Avenue, Suite 3320
Seattle, WA 98101
(206)292-2387
www.navigantconsulting.com



Hansine & Fisher Associates
3635 SW Dosch Road
Portland, OR 97239
(503) 579-1010

www.hfa3.org



MJ Care, Inc.
2448 South 102nd Street, Suite 340
Milwaukee, WI 53227
1-800-359-1046 Ext. 425
www.medicaid.mjcare.com



Fairbanks LLC
500 N Michigan Avenue, Suite 300
Chicago, IL 60611-3775
(312) 321-1225
www.fairbanksllc.com